

# Automatizarea ARC-Lite

Sercan Kurtuluş

HC-CW/PAE

20.03.2024

Versiunea in limba Romana ing Galati  
Andrei

# Final Product Information / ARC-Lite

## Conținut

01

### Introducere

Foaie de parcurs și introducere treptată, informații privind eliminarea treptată

02

### Denumire

Numele produselor, țările și limbile

03

### Informații despre produs

Caracteristici și noutati

04

### Compararea funcționalităților

ARC Products Caracteristici Matrix

05

### Prezentare generală a sistemului

Conexiune și compatibilitate

06

### Logistica

Harta generală a livrărilor

# 01

## Introdurre

# Final Product Information / ARC-Lite

## Introducere

- Versiune: 1.0
- Branduri: Bosch

# Final Product Information / ARC-Lite **Introducere – Domeniul de aplicare al proiectului de produs**



Grupa de produse:

Controler de cameră pentru gama VRF

Tipul produsului: ARC L (Lite)○



Proiecte VRF comerciale, industriale și rezidențiale

Produs de luptă pentru prețuri pentru completarea portofoliului și îmbunătățirea competitivității pe piețele VRF



WEU (ES, PT, PL, DE, FR, IT,)  
EEU (TR,UA, RO, HR, GR, BG)



○ Compatibil cu AF2, AF4300A & AF5301



SAP No	Type	Nume produs	Tip produs	Descrierea SAP
7738113943	Controller	Air Room Control	ARC L	Controler de cameră VRF

# Final Product Information / ARC-Lite

## Portofoliul de produse în 2024

### Air Room Controllers



ARC C IR-2



ARC C-2



ARC H-2



ARC L

# 02

## Denumiri

# Nomenclature Controlere de cameră, globale

Tipul produsului: ARC ... ..

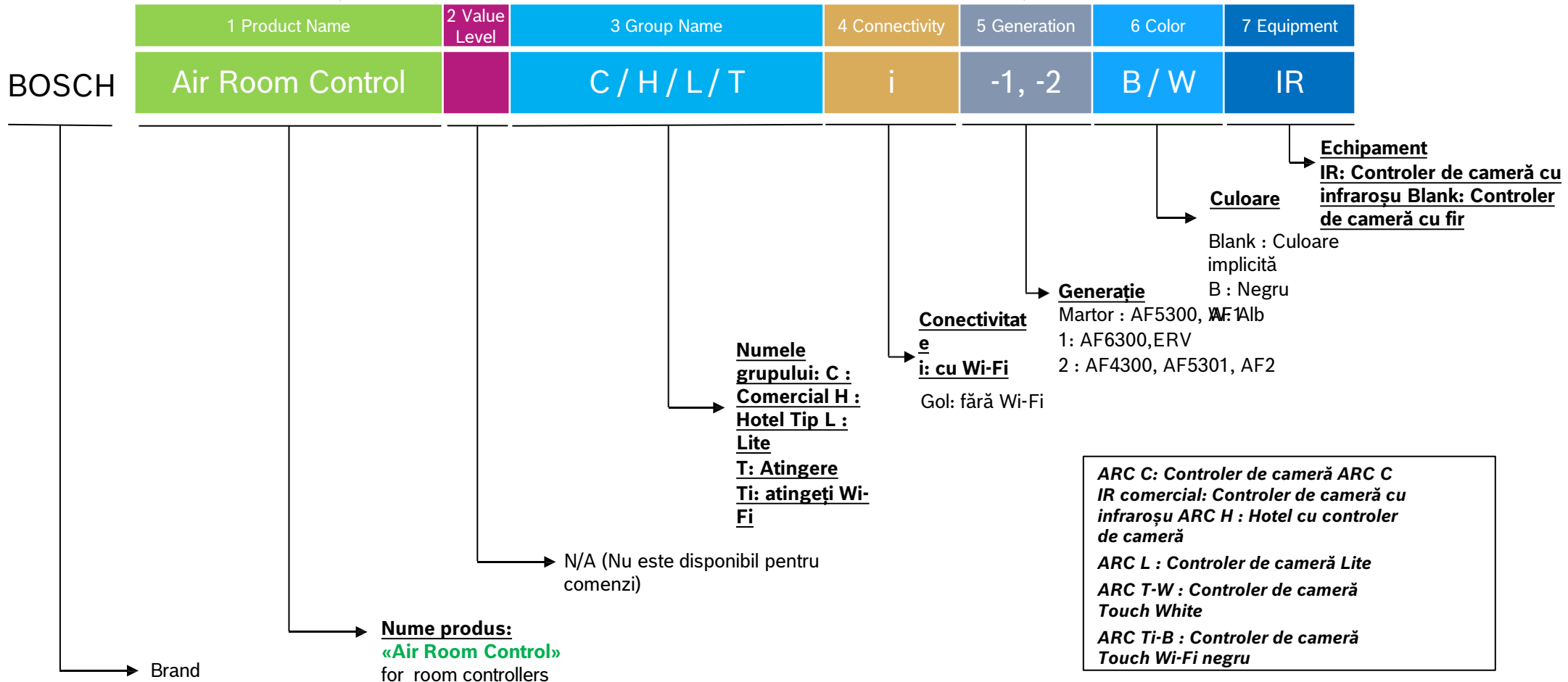

# 03

## Informații despre produs

# Product Information ARC – Lite / Cunoștințe de bază

- Dimensiune compactă: 88x88mm
- Butoane tactile interactive înalte
- ARC C aceeași utilizare a plăcii dorsimale
- Slim and flat design
- Interfață simplă ușor de utilizat

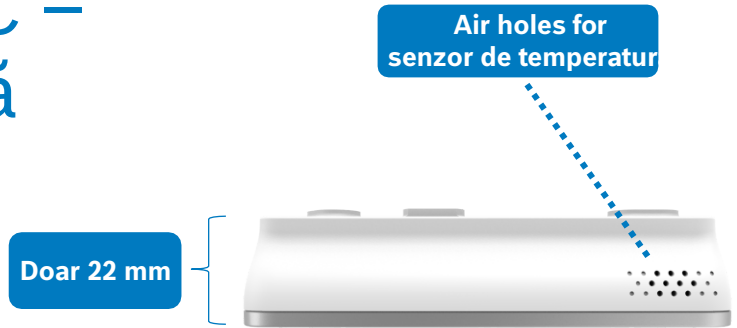

# Product Information

## ARC – Lite / Caracteristici & Funcții

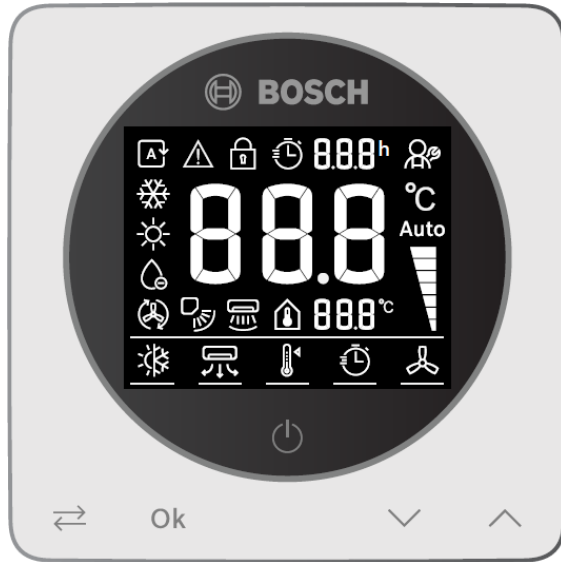

### Functions

	Mode setting selected
	Mode setting unselected
	Louver setting selected
	Louver setting unselected
	Temperature setting selected (default)
	Temperature setting unselected
	Timed mode setting selected
	Timed mode setting unselected
	Fan speed setting selected
	Fan speed setting unselected

### Others

	Indoor temperature
	Timed mode
	Lock
	Warning
	Service/maintenance mode
<b>Auto</b>	Fan speed auto mode

# Product Information

## ARC – Lite / Setări mod și clapete

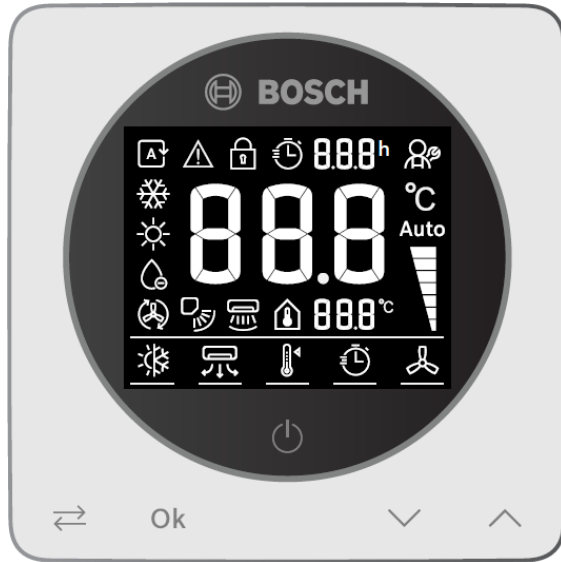

### Mode

	Auto mode
	Cooling mode
	Heating mode
	Dry mode
	Fan mode

### Louver setting

	Auto	Horizontal
	Swing angle 1	
	Swing angle 2	
	Swing angle 3	
	Swing angle 4	
	Swing angle 5	Vertical
	Auto swing	
	No swing	

# Product Information

## ARC – Lite / Setări serviciu

- Numărul intermitent indică selecția curentă (fie parametru, fie setare)
- Comutați între parametru și setare apăsând OK
- Confirmați setarea cu OK, reveniți la selectarea parametrilor
- Ieșiți din meniul serviciului apăsând butonul de comutare a modului sau inactivitatea timp de 60 de secunde



Țineți apăsat ambele butoane timp de 3 secunde pentru a intra în meniul de servicii (ascuns)

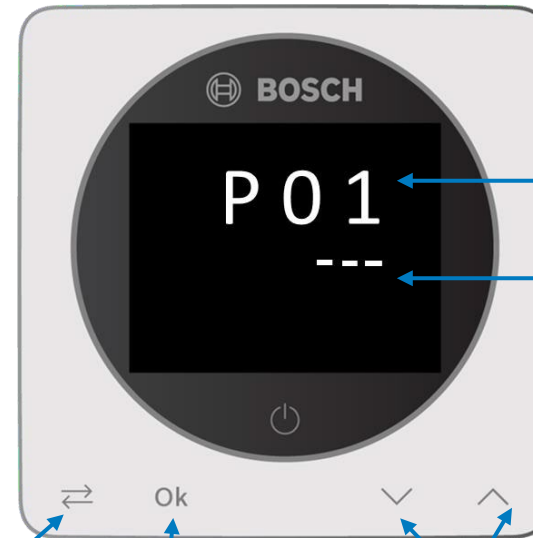
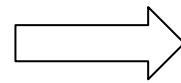

Ieșiți din serviciu menu

Confirmați parametrul/setarea

Modificați valoarea

Selectați parametrul

Setarea selectată parametru

# Product Information

## ARC – Lite / Setări serviciu

- Potrivirea codurilor parametrilor și a codurilor de setare cu ajutorul manualului de instalare
- Detaliile serviciului pot fi găsite la manuale

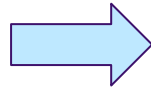
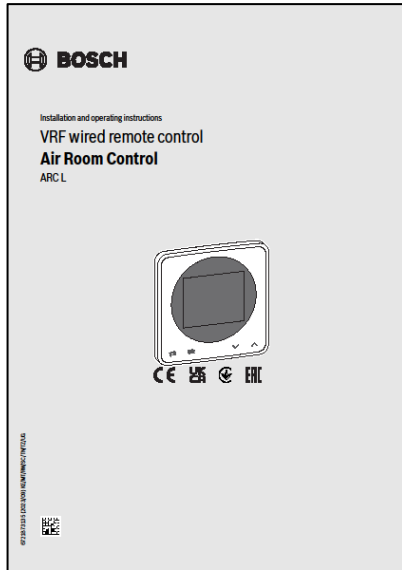

**BOSCH** Shutting down / switching off

### 6 Shutting down / switching off

The user interface is supplied with power via the BUS connection and is always on. The system is however shut down for maintenance purposes for example.

- ▶ Disconnect power from the entire system and all BUS nodes.

**i**

All the settings are retained permanently after a power failure. After the system is switched on again, an automatic search for available units is started.

### 7 Service menu

- ▶ If the standard display is active: press the **Ok** and  $\checkmark$  button simultaneously and keep them depressed for approx. 3 seconds. Service menu P01 is displayed.
- ▶ Change flashing displays with the  $\checkmark$  and  $\wedge$  buttons (e.g. From P01 to P02).
- ▶ Select / confirm the flashing display with the **Ok** button.
- ▶ To cancel the current settings: press the  $\leftarrow$  button.
- ▶ To exit the service menu: press the  $\odot$  button.
- ▶ From the main menu (PXX flashes): press the  $\leftarrow$  button.

**i**

The  $\odot$  button closes the service menu from any position, while the  $\leftarrow$  button closes the service menu completely only from the main menu.

After three minutes without action, the service menu is automatically closed. The display shows the last view before the service menu was called up.

**i**

The factory settings during commissioning are **highlighted** in the following tables. In the case of a few settings, the default setting is subject to the system components.

Menu	Description
<b>P01</b>	If the outdoor unit allows the device addresses to be set manually ( $\rightarrow$ Technical documentation for the outdoor unit), the device addresses for the units can be changed here. Settings: • 0 ... 255 Every unit can be assigned a new device address. Appliance addresses already used cannot be assigned a second time.
<b>P02</b>	Capacity of indoor unit in kW.
<b>P03<sup>1)</sup></b>	After repairing the system and replacing the R32 refrigerant sensor, reset the corresponding fault (R32 refrigerant leak). Settings: • - / 1 (= reset the fault) For safety reasons, the R32 refrigerant sensor must be completely replaced in order to ensure for a correct functionality.
<b>P04</b>	Reset the remaining runtime in emergency operation Settings: • - / 1 (= reset the remaining runtime)
<b>P05<sup>2)</sup></b>	Select the temperature sensor for controlling the unit. Settings: • Arc: Temperature sensor in the control unit • ldu: Temperature sensor in the unit
<b>P06</b>	Calibrate the room temperature sensor of the control unit. If the temperature displayed on the user interface differs from the temperature of the actual room temperature, the temperature displayed can be corrected by adjusting the temperature offset. Adjustment range in steps of 0.5 °C: -5.0 ... <b>0</b> ... 5.0 °C
<b>P07</b>	Switching interval in automatic mode $\square$ Settings: • <b>15</b> /30/60/90 min
<b>P08</b>	Activating / deactivating the automatic modes $\square$ , cooling mode $\square$ , heating mode $\times$ , dehumidifying mode $\square$ and fan mode $\square$ . Settings: • 0: Operating mode deactivated • 1: Operating mode activated ▶ Change flashing displays with the $\checkmark$ and $\wedge$ (e.g. from $\square$ to $\square$ ). ▶ Change between operating mode and setting with the $\leftarrow$ button. ▶ Confirm with the <b>Ok</b> button and exit the menu.

Service menu

Menu	Description
<b>P09</b>	Activate / deactivate the functions of the blade alignment $\square$ and timer $\square$ . Settings: • 0: Function not possible • <b>1</b> : Function possible ▶ Change flashing displays with the $\checkmark$ and $\wedge$ (e.g. from $\square$ to $\square$ ). ▶ Change between function and setting with the $\leftarrow$ button. ▶ Confirm with the <b>Ok</b> button and exit the menu.
<b>P10</b>	Defines whether units are automatically restarted following a power failure. Settings: • 0 = No automatic restart • <b>1</b> = Automatic restart
<b>P11</b>	External static pressure is only relevant for units designed for installation in ducts. Each individual unit is assigned via the device address. Depending on the unit, the external static pressure can be set automatically or via up to 20 steps. Settings: • <b>A</b> = Automatic allocation • 0 = No external static pressure • 1 ... 19. Levels of the external static pressure For more information $\rightarrow$ technical documentation of the unit.
<b>P12</b>	To prevent excessively cold air being blown out in heating mode, the fan of the unit is stopped in the range below this temperature (average temperature of the heat exchanger of the unit). Settings: • <b>15</b> /20/24/26 °C
<b>P13<sup>3)</sup></b>	Set the temperature compensation in heating mode for control via the temperature sensor of the unit. In heating mode warm air concentrates near to the ceiling. The temperature gradient resulting from this in the room can be controlled by adjusting the temperature compensation. Settings: • 0/2/4/6/8 °C
<b>P14</b>	Define the behaviour of the fan, after the set temperature has been reached in heating mode. Example: Setting at 4 min means that the fan alternates between pausing for 4 min and operating for 1 min. Settings: • <b>4</b> /8/12/16 min

# 04

## **Compararea funcționalităților**

# Functionality Comparison

## ARC Characteristicile produselor



Features	ARC C-2	ARC H-2	ARC L
Dimension (GxYxD) mm	123x101x25	123x120x25	88x88x22
On / Off Control	✓	✓	✓
Modes (Cooling,heating, dry, fan)	✓	✓	✓
Temperature setting	0.5°C	0.5°C	0.5°C
Room temperature display on home-screen	✓	✓	✓
Date and time information on home-screen	✓	-	-
Outdoor temperature on home-screen	✓	✓	-
Turn-OFF LED of the indoor unit	✓	✓	✓
Sleep Mode	✓	✓	-
Child Lock	✓	-	-
LED display with back light	✓	✓	✓
Filter clean reminder	✓	✓	-
Louver Setting / Air direction	✓	✓	✓
Individual Louver Settings - <b>New!</b> (only with AF2 & AF4300A)	✓	✓	-
Humidity Set - <b>New!</b> (only with AF2 & AF4300A)	✓	-	-

# Functionality Comparison

## ARC Characteristicile produselor



Features	ARC C-2	ARC H-2	ARC L
7 Step fan speed	✓	✓	✓
Auto swing (*supported models only)	✓	-	✓
5 step louver angle (*supported models only)	✓	-	✓
Adress setting	✓	✓	✓
2-way communication	✓	✓	✓
Group control (up to 16 units ERV and or regular indoor units)	✓	-	-
Twin controller	✓	-	-
Schedule	✓	-	-
Timer on/off	-	-	✓
Summer winter time switch	✓	-	-
Follow me	✓	✓	-
Eco	✓	-	-
Eco+ - <b>New!</b> (only with AF2 & AF4300A)	✓	-	-
Night Silent Mode (Service Settings) - <b>New!</b> (only with AF2 & AF4300A)	✓	-	-
Absence Optimization (Human Sensor) <b>New!</b> (only with AF2 & AF4300A)	✓	-	-

# Functionality Comparison

## ARC Characteristicile produselor



Features	ARC C-2	ARC H-2	ARC L
Error history	✓	✓	-
Error description	✓	✓	✓
Multi-language support	✓	✓	✓ (language neutral)
Integrated dry-contract	* Back-plate	✓	* AF2 indoor units
Monitor system parameters	✓	✓	-
De-activate modes	✓	✓	✓
Away mode	✓	-	-
Power cool & Power heat	✓	-	-
External static pressure (*supported models only)	✓	✓	✓
Self-cleaning <b>New!</b> (only with AF2 & AF4300A 8-18 kw R32 types)	✓	✓	-
Service Mode	✓	✓	✓
Service contact information	✓	✓	-
Context sensitive information	✓	✓	-
Min & Max temperature settings	✓	✓	-
Control ERV units	✓	-	-

# 05

## **Prezentare generală a sistemului**

# Wiring & Connectivity

## Opțiuni posibile– ARC L (Lite)

### Possible applications

One control unit ARC L controls one unit.

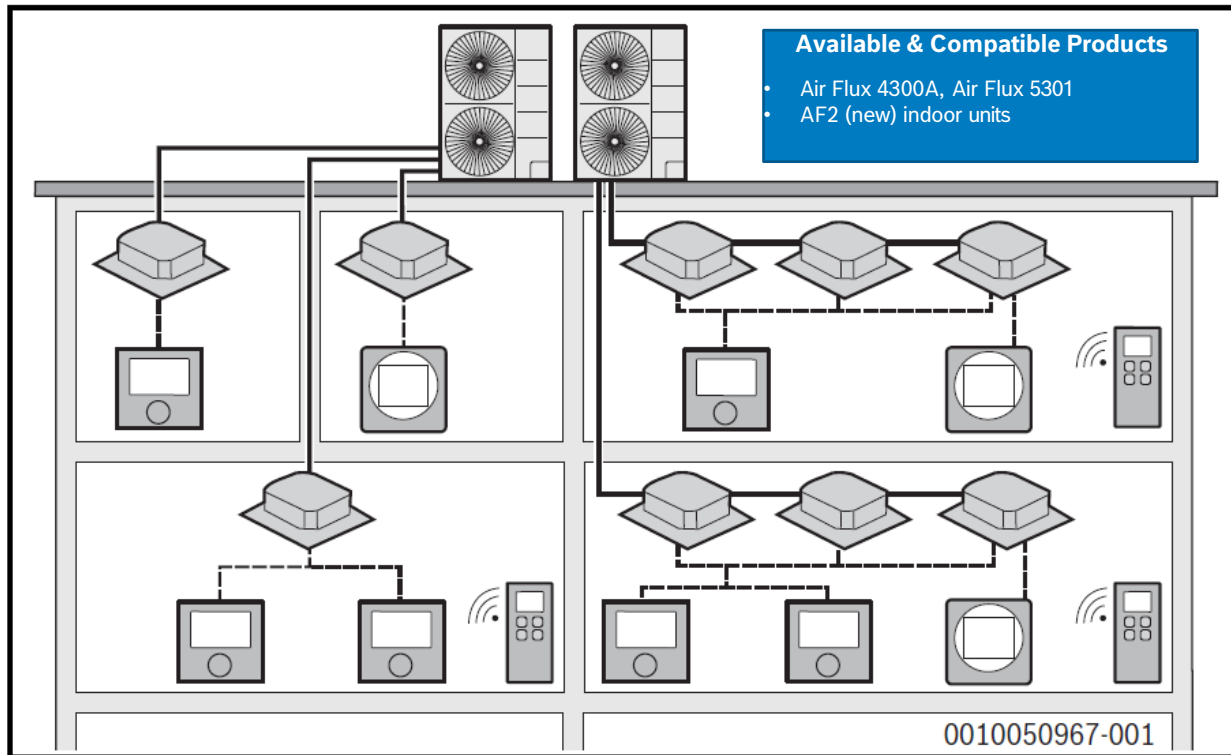

Symbol	Designation
	Air Flux outdoor unit
	Air Flux indoor unit
	Room Controller VRF ARC C-2/ARC H-2
	ARC L wired remote control
	Infrared Room Controller ARC C IR-2





- Conexiune unu-la-unu (ARC la o singură unitate interioară)
- ARC - Lite întotdeauna în modul slave, atunci când există
- Controlere multiple la sistem

# Compatibility Matrix

## Controlere de

**Compatibility Notes**

- ✓ Full functions
- ✗ No compatibility
- ✓ Limited functions

Product	Picture	Ver.	AF-1&2	AF2	ERV-1	ERV-2	MDCI	AF5300	AF6300	AF4300	AF5301
ARC C		0	✓	✗	✗	✗	✓	✓	✗	✗	✗
		1	✓	✗	✓	✗	✓	✓	✓	✗	✗
		2	✓	✓	✓	✓	✓	✓	✓	✓	✓
ARC H		0	✓	✗	✗	✗	✓	✓	✗	✗	✗
		1	✓	✗	✗	✗	✓	✓	✓	✗	✗
		2	✓	✓	✗	✗	✓	✓	✓	✓	✓
ARC L		0	✗	✓	✗	✗	✗	✗	✓	✓	✓
ARC C IR		0	✓	✗	✗	✗	✓	✓	✓	✗	✗
		2	✓	✓	✗	✗	✓	✓	✓	✓	✓

# Bosch AF4300A Platform Arhitectura sistemului - Prezentare generală

\*AF4300 compact works with R410 that's why R32 functions are not available

\*ARC Lite planned DR Q2.24 / Product Under Dev.

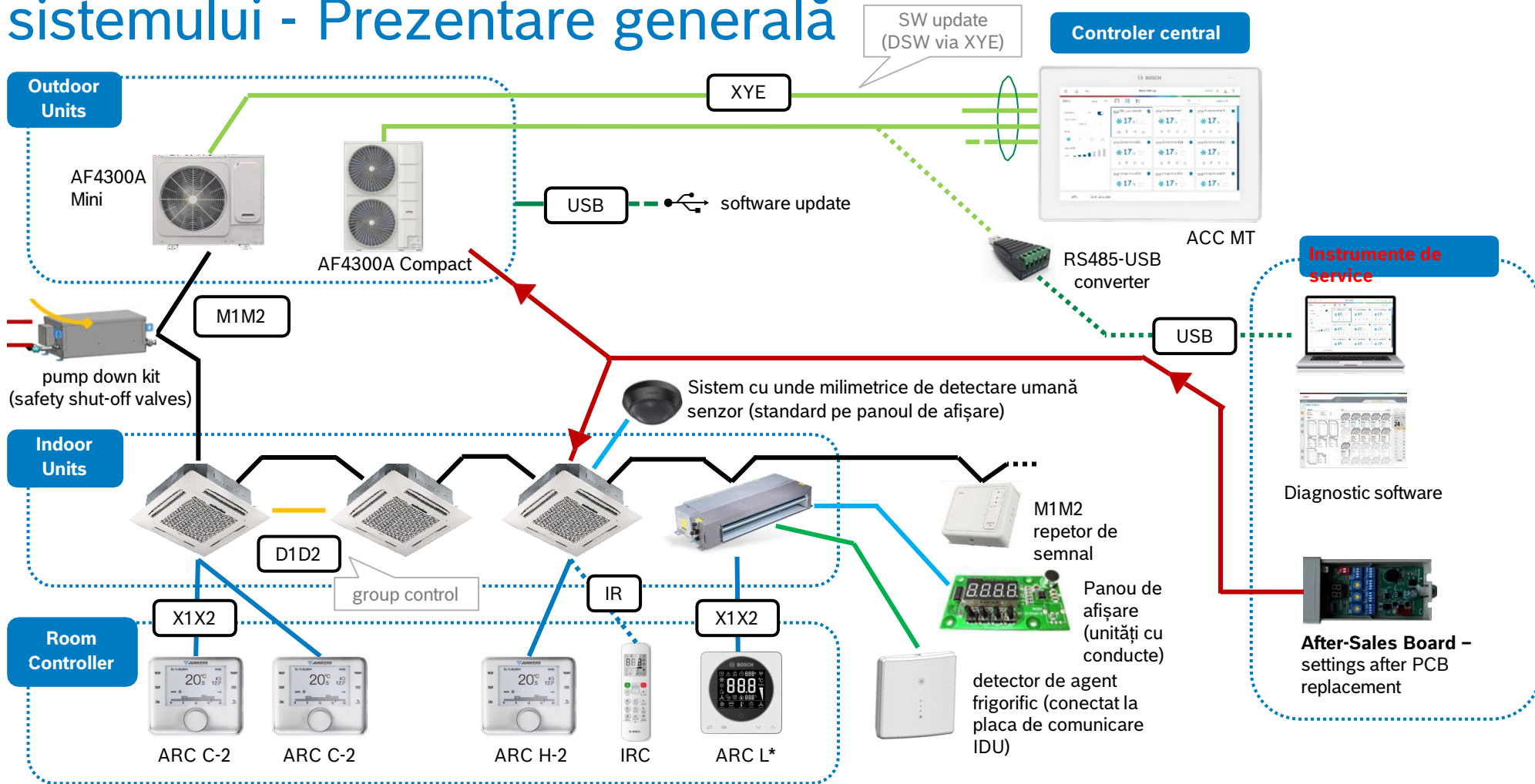

# Bosch AF5301 A Platform Arhitectura sistemului - Prezentare generală

\*ACC Gen2 products planned DR is Q2.25 / Product development project initiated

\*ARC Lite planned DR Q2.24 / Product Under Dev.

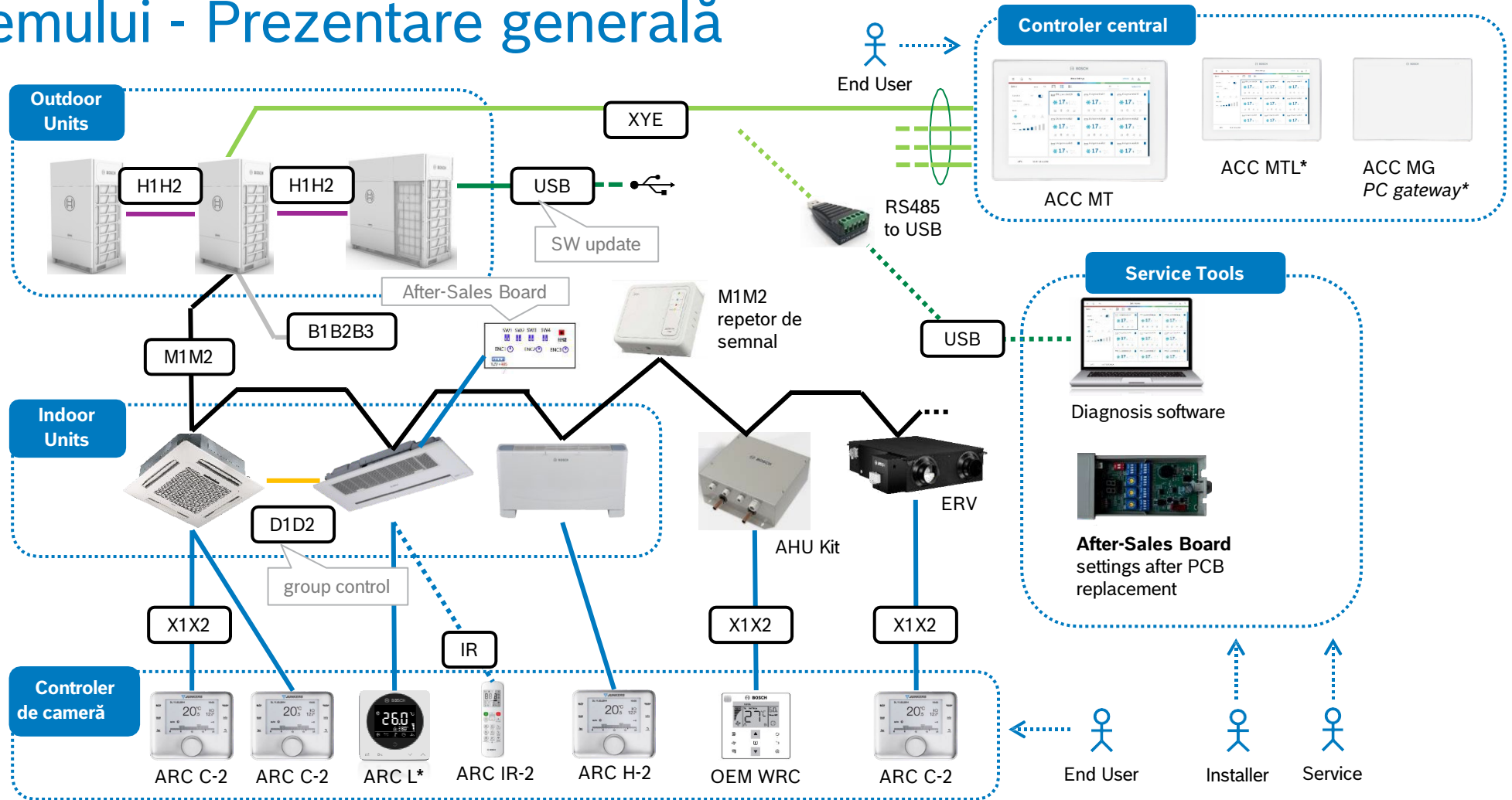

# 07

## Manuale

# Final Product Information / ARC-Lite

## Conceptul de documentare

- ARC Lite inclusiv «Ghid de pornire rapidă»; click pentru a deschide
- Informații de bază despre instalare și funcționare
- Inclusiv "cod QR" pentru a accesa manuale detaliate de instalare și operare
- Ecrane de service pentru controlere
- Ghid de pornire rapidă

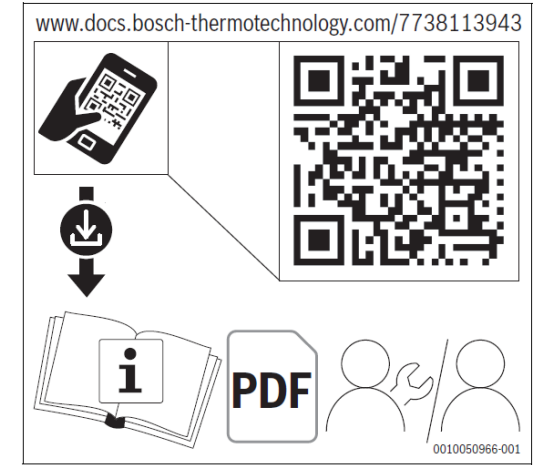
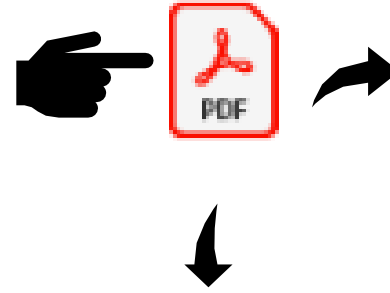

2

Air Room Control – 6721871340 (2023/09)

3

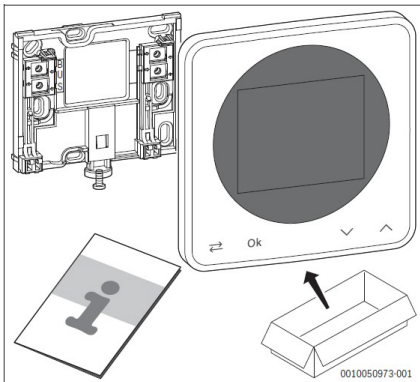

1

Air Room Control – 6721871340 (2023/09)

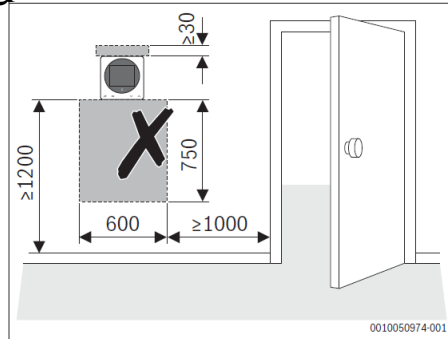

4

Air Room Control – 6721871340 (2023/09)

5

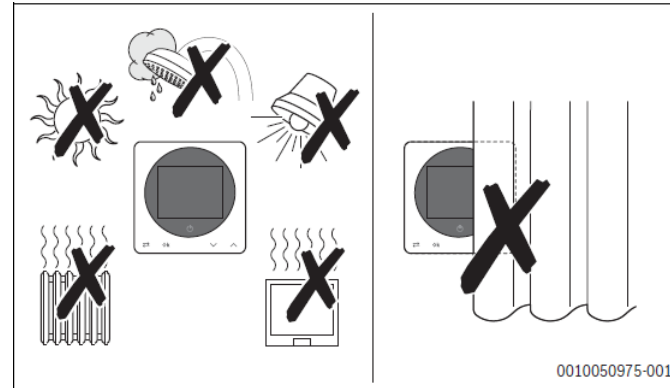

5

0010050975-001

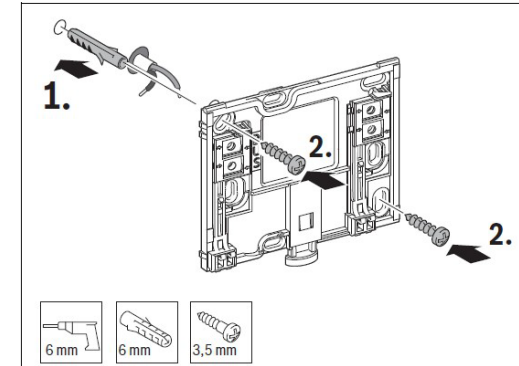

1.

2.

